

User Manual (for T988,T1288 tonearm models)

Warnings

Do not expose the equipment to rain or moisture.

Do not remove the cover from the equipment.

Do not insert anything into the equipment through the ventilation holes.

Do not handle the mains lead with wet hands.

No naked flame sources, such as lighted candles, should be placed on the equipment.

Table of Contents

1. Package contents	2
2. tonearm mounting	2
3. Technical data	7
4. Warranty	8

1. Package contents

The **consonance T988 /T1288** tonearm is delivered in specially designed packaging to ensure its safe transport. Please check the contents as shown in picture below and in the list at the bottom of this page:

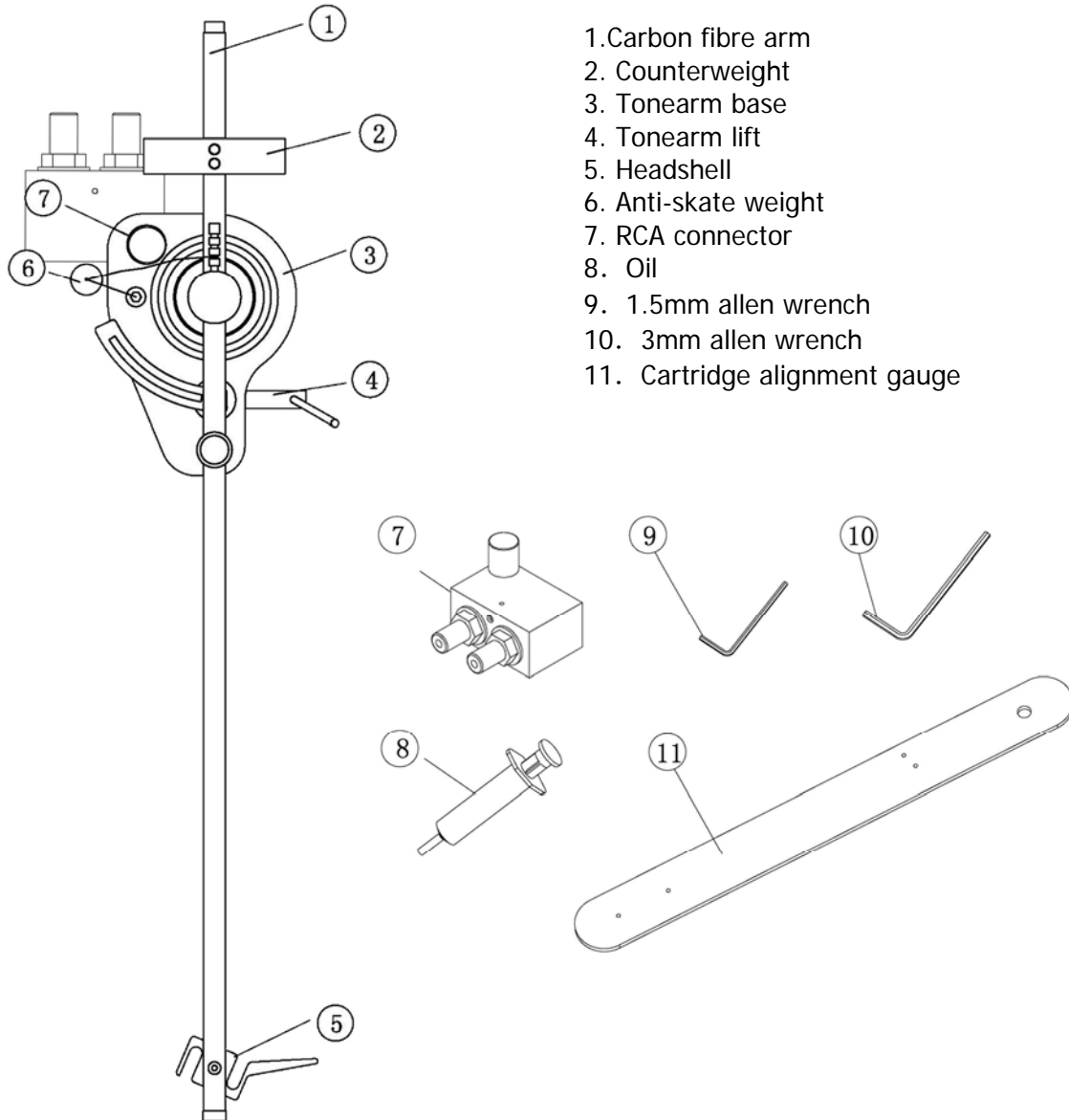

2. T988 and T1288 tonearm mounting

Please keep in mind that these directions are for mounting the T988 and T1288 tonearm on any **Consonance** turntable. Installation on other brand turntables is possible but not covered in this manual.

Please refer to the turntable manufacturer's user manual.

1. Fitting and connecting the cartridge. All cartridge with half inch mounting holes can be fitted. Do not tighten the nuts yet. Connect the tonearm wire to the cartridge pins as follows: white(L+), red(R+), green(R-), blue(L-).

2. Make sure that the distance from the spindle to the pivot point of the tonearm is exactly 214 mm for the T988 and 290mm for the T1288. When moving the armboard in one direction or another you can locate the correct armboard position, a ruler is included in helping in proper setup adjustment. If you are the owner the Consonance turntable 'Liu' or the 'LP 3.1' the hole is already located for the proper setup position for these tonearms.

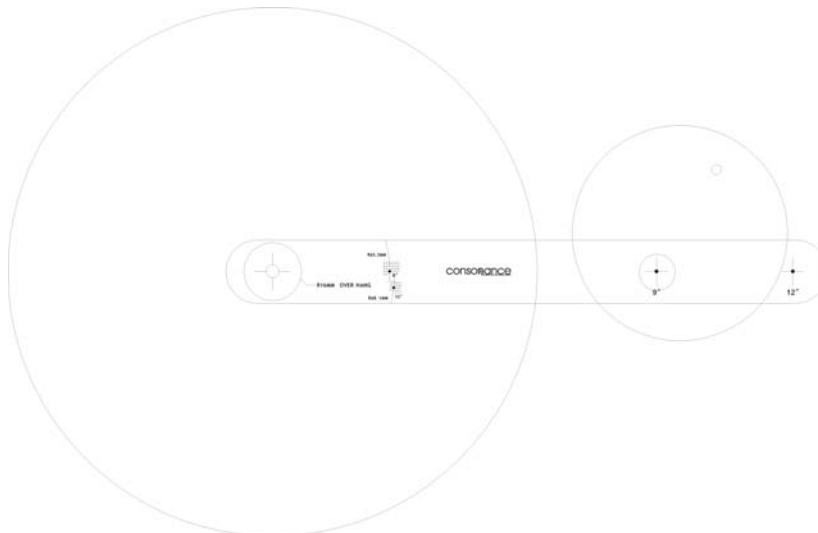

3. As illustrated use the silicon oil in the syringe and place a few drops, enough to cover the bearings, inside the tonearm bearing well. Then place the tonearm on the bearing well making sure that the 'male' part of the bearing is sitting in the 'female' bearing.

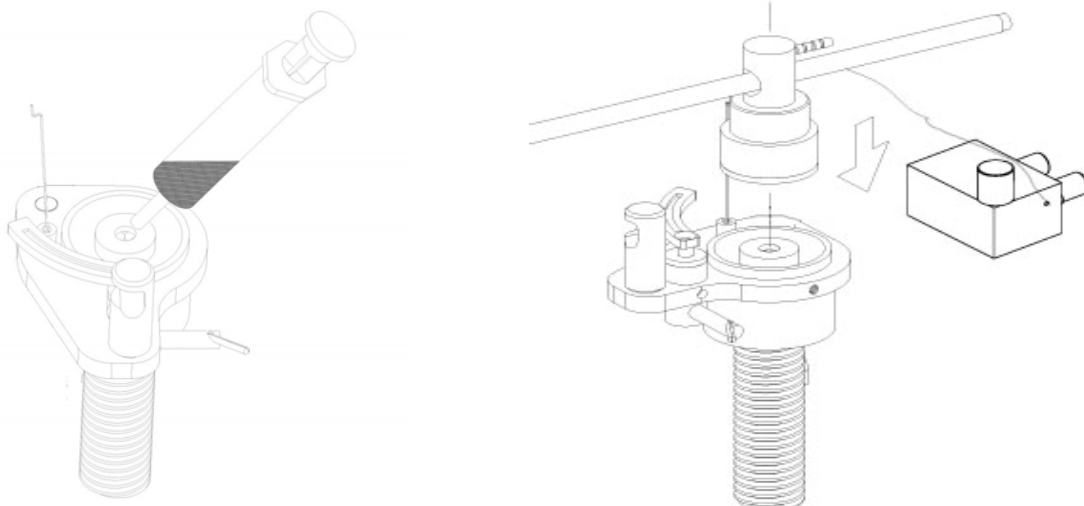

4. In this picture you must secure the tonearm cable connection using the supplied 1.5mm allen wrench. After you place the connection inside the hole in the tonearm base use the allen wrench to tighten the allen screw, located on the side of the base.

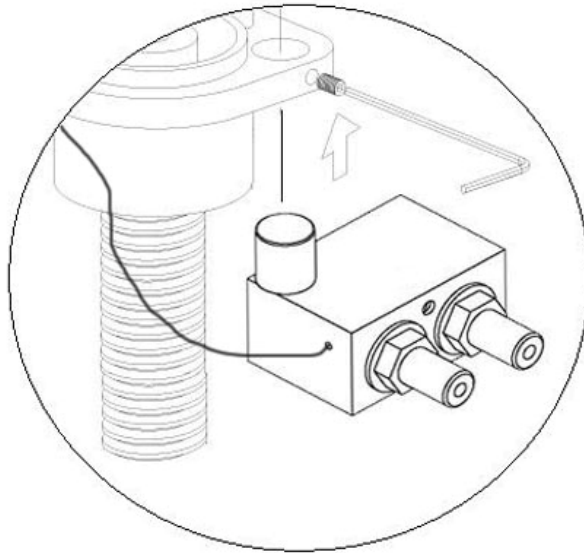

5. Slide the counterweight on the shaft of the tonearm. Lock the weight in its position by tightening the screws in the weight. This is only a temporary fixed position, the final adjustment will be done during cartridge installation.

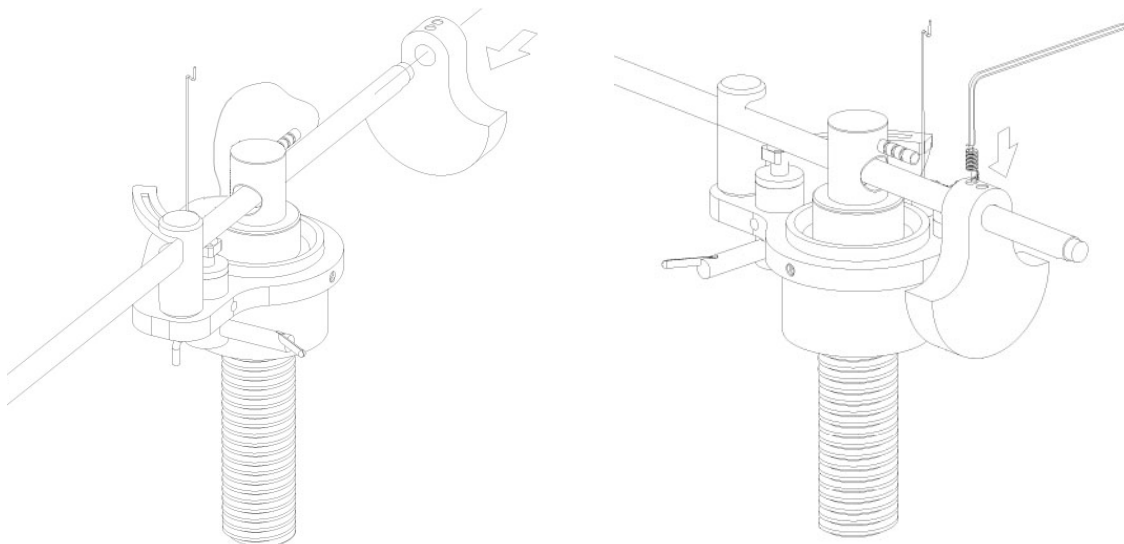

6. Mount your cartridge according to the manufacturer's instructions. Align cartridge for overhang (16mm) and offset angle

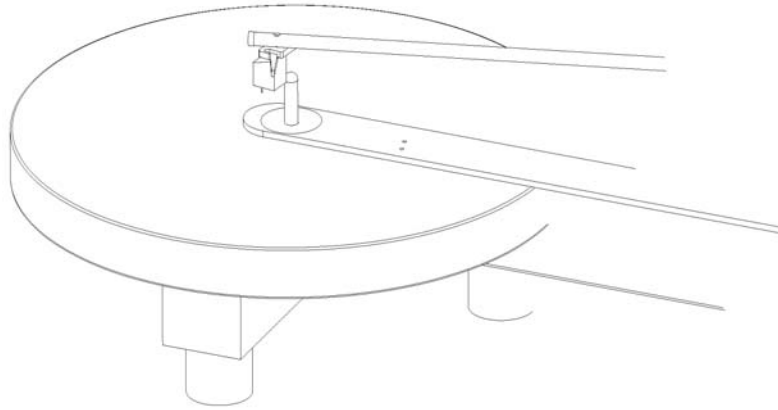

7. Use the scale to set tracking force (see cartridge instructions for recommended tracking force range). Adjusting tracking force is accomplished by moving the weight towards or away from the pivot point on the shaft.

8. Align cartridge for overhang (16mm) and offset angle using the Consonance Cartridge alignment gauge. Once done, re-check tracking force.

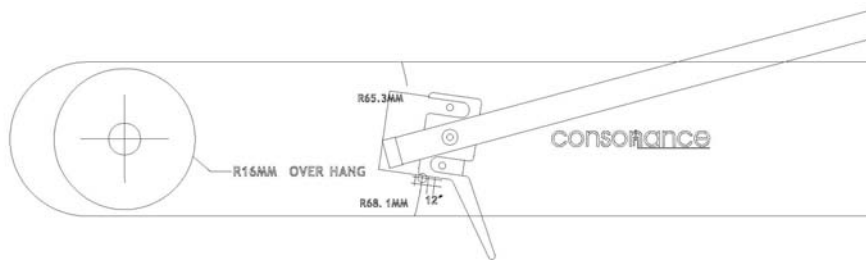

9. Feed the anti-skate weight through the anti-skate support wand and secure it to one of the three locations (according to the anti-skating adjustment for your cartridge) on the shaft at the top of the tonearm bell.

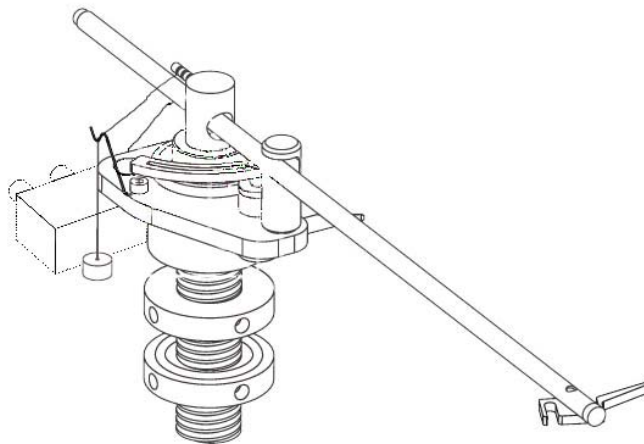

Note: The anti-skating force is adjusted according to the mass of the cartridge as follows:
T988's downforce: 10-14mN, 15-19mN, 20mN and bigger (Groove in the stub 1st, 2st, 3st from bearing rings).

T1288's downforce: 8-11mN, 12-14mN, 15mN and bigger (Groove in the stub 1st, 2st, 3st from bearing rings).

When tightening the counter-weight, insure that the weight is perfectly vertical otherwise this may affect your cartridges azimuth settings.

10. VTA adjustments are accomplished by adjusting the two large washers on the bottom of the threaded tonearm base shaft. Before you place the tonearm through the arm base hole make sure one of the threaded washers is already in place. After placing the the tonearm through the base, screw the second one onto the bottom of the shaft. Make the proper

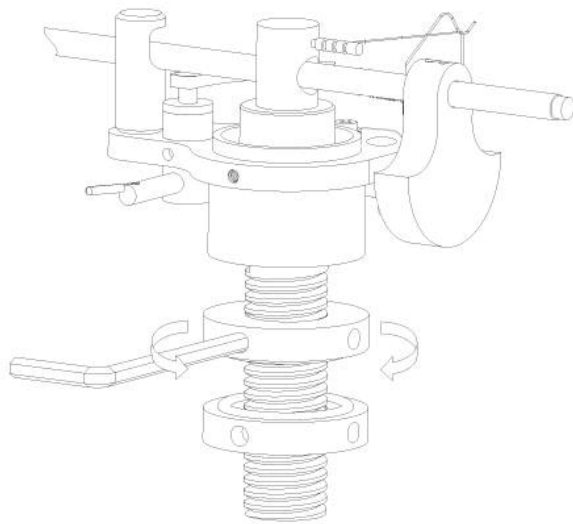

adjustments (first by hand) to reach the proper vertical tracking position then use the 3mm allen wrench to help make a tighter secure fit. After this use the 3mm allen wrench to tighten the screws located around the edge of the threaded washers. Be careful not too tighten these screws too much. Just make sure they are properly secure so that the washers don't become lose over time.

11. offset adjustments are facilitated through the small (3 mm) allen screw on the top where the headshell connects with the arm.

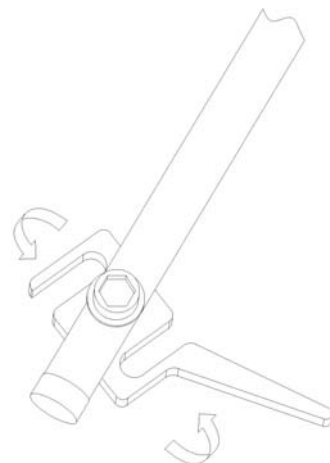

12. In addition, if you want more damping, place as much damping oil as you desire in the large tonearm oil cup. The amount of oil is up to your personal taste. Experimentation is necessary.

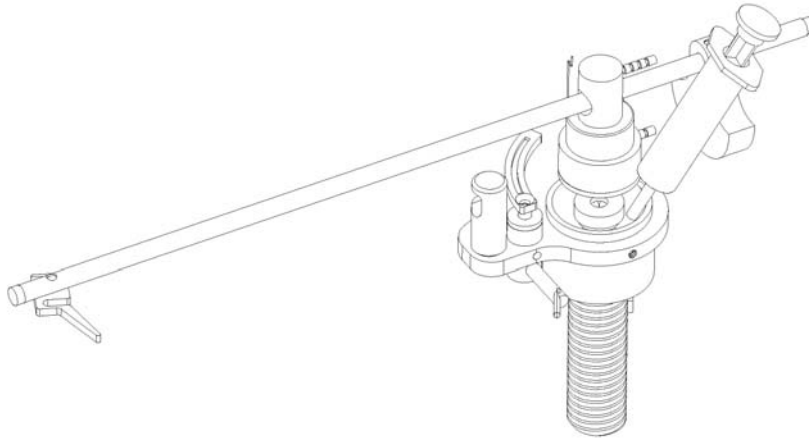

TECHNICAL SPECIFICATION

	T988	T1288
Mounting distance arm base	214mm	290mm
Tonearm length	9"	12"
Armtube made of	carbon-fibre	carbon-fibre
Overhang	16mm	16mm
Offset	23 degree	22 degree
Cartridge weight	4-22g	3-15g
Downforce range	10-35mN	10-35mN
Weight(without counterweight)	52g	55g
Counterweight	85g	93.6g

WARRANTY

Opera audio guarantees each product manufactured by us to be free from defects in materials and workmanship under normal use. Our obligation under this warranty is limited to making good at our factory any part or parts thereof which shall, within 1 year after delivery to the original purchaser, be returned to us with transportation charges prepaid, and which an examination shall disclose to have been thus defective; this warranty being expressly in lieu of all other warranties expressed or implied and of all other obligations or liabilities on our part. This warranty shall not apply to any Opera audio product which shall have been repaired or altered outside of our factory in any way so as to affect its stability, nor which has been subject to misuse, negligence or accident. Warranties of the vacuum tubes are by the respective manufacturers, usually 90 days.

Please mail or e-mail the Registration Card to the address as follows:

The Opera Audio Co., Ltd.

No.2 JianXianQiaoLu
ChaoYang District
Beijing, China
Tel: 86 10 59789461
Fax: 86 10 59789465

support@opera-consonance.com
www.opera-consonance.com



Registration Card

Name
Address
City
State
Zip
Email
Telephone
Model
Serial Number
Purchase Date
Dealer